

Assembly Instructions
414 Eon Guest Chair

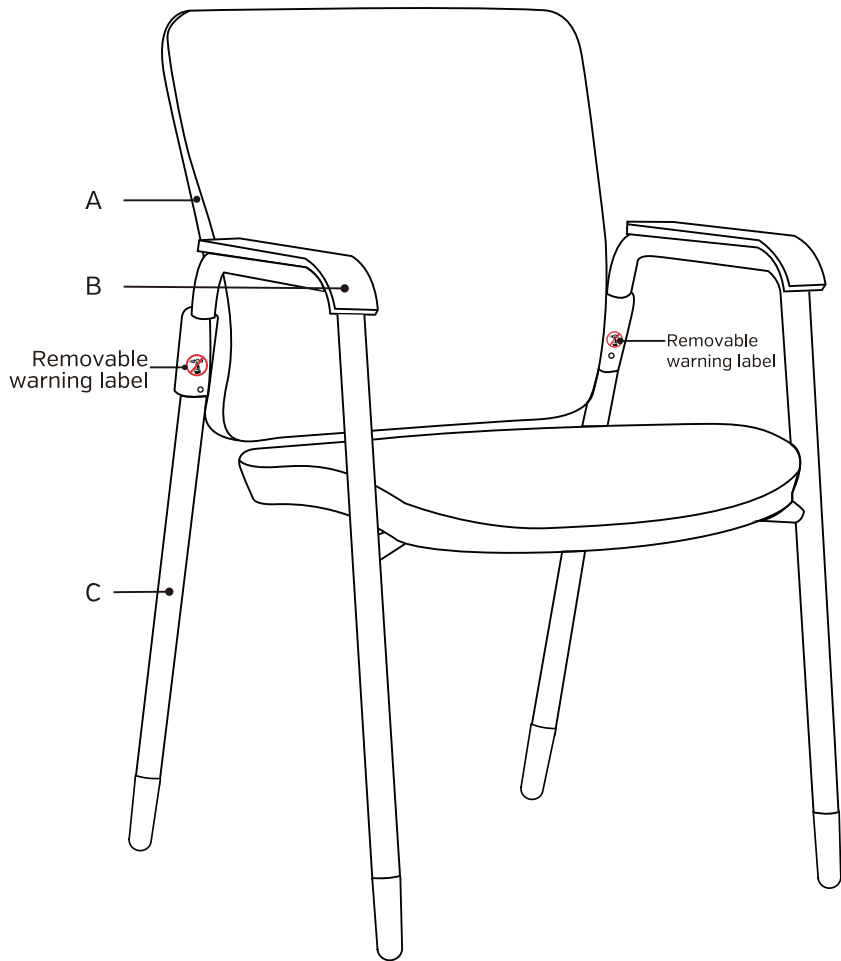

Item		Part Name	Part #	Qty
A		Back Frame	G00324/G00326	1
B		Arm Frame	G00325/G00327	1
C		Back Leg	G00044	2
D		Flat Washer	G00045	2
E		Long Bolt	G00046	2
F		Short Bolt	G00073	2
G		4mm Hex Wrench	G00066	1
H		6mm Hex Wrench	G00048	1
J		Leg End Cap	G00049	4
K		Front Leg Caster Insert [2] [Optional]		
L		Back Leg Caster Insert [2] [Optional]	403CASTERS	1
M		Casters [4] [Optional]		
N		Spring Washer	G00242	2

Warning

1. Product is for single person use only.
2. Do not use this chair unless all bolts and knobs are securely tightened.
3. Check that all bolts and knobs are tightened every six months or as needed.
4. Dispose of packing material properly. Do not use plastic cover as a head covering. Suffocation may result.
5. Do not use this chair as a stepladder.

For assistance, call [888] 471-1616, or visit www.cherrymanindustries.com

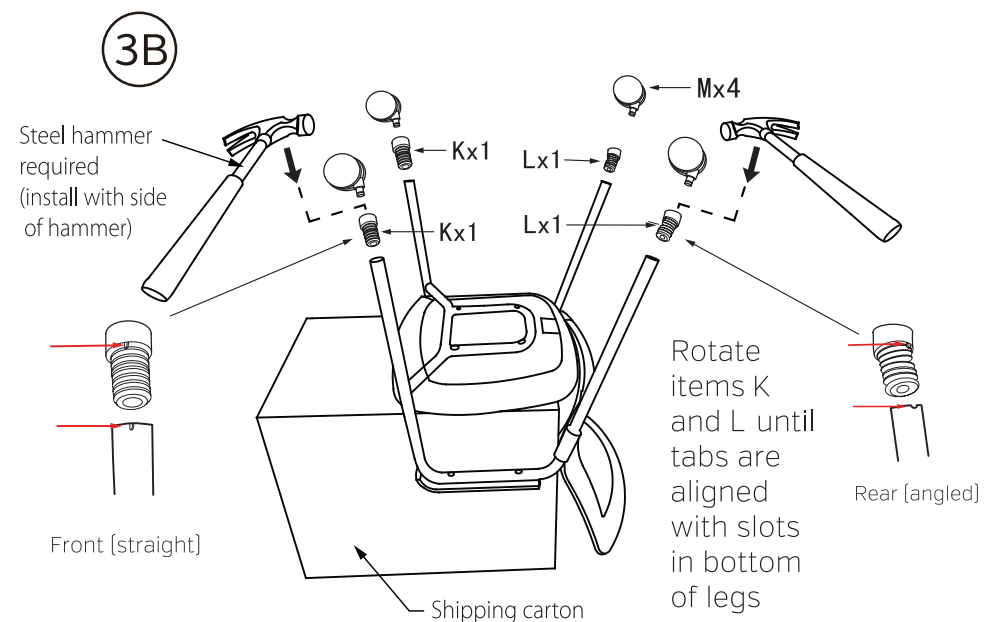
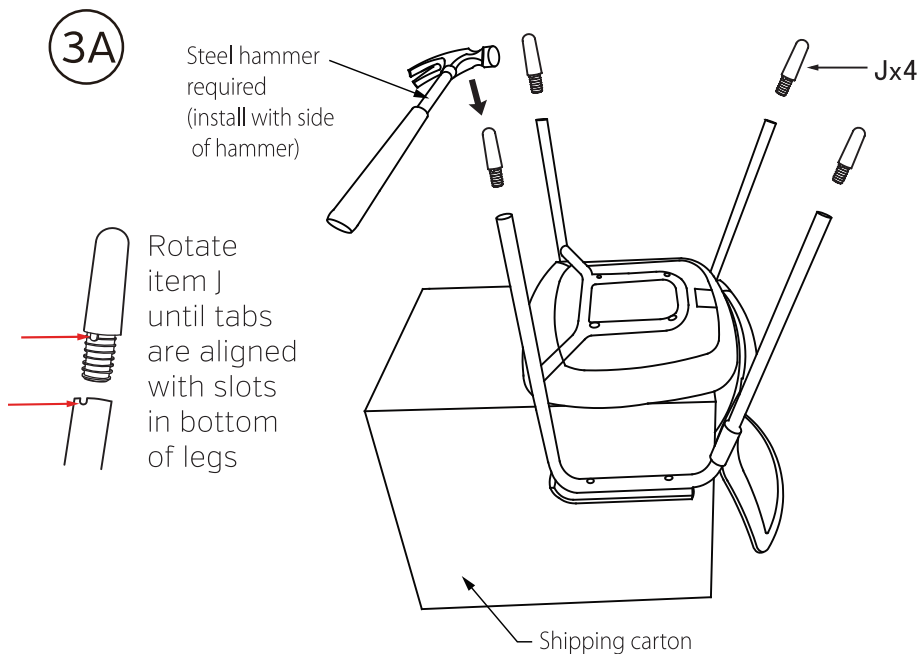
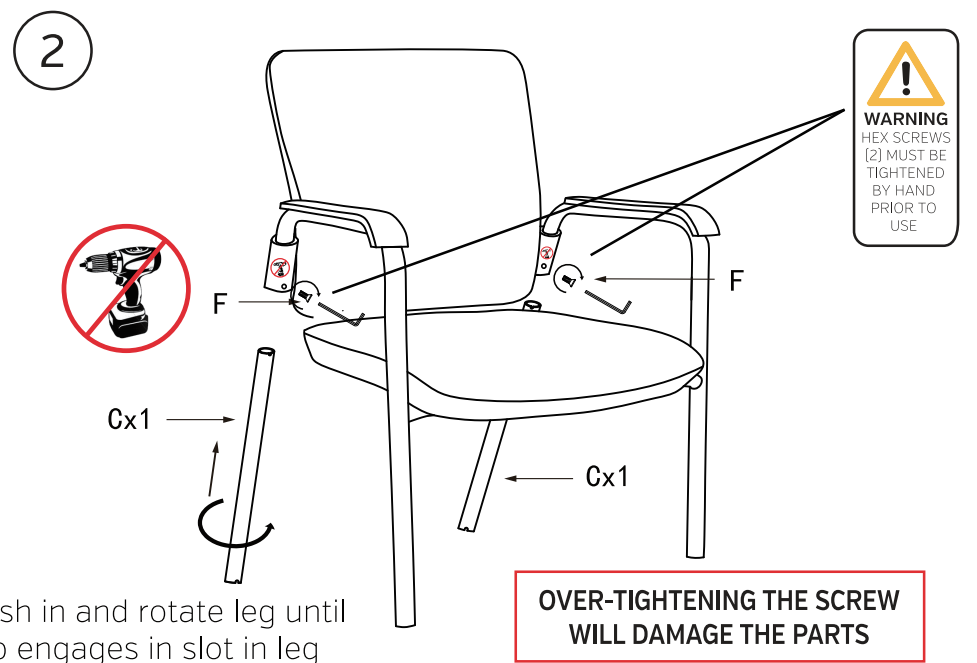
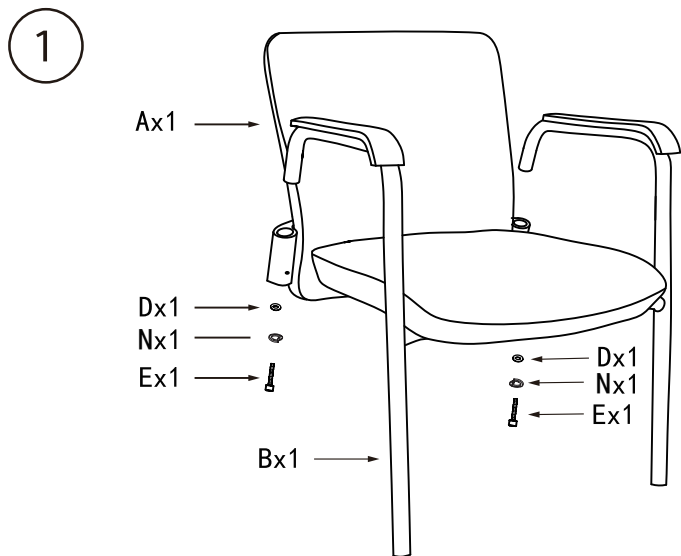

Assembly Instructions Slip Cover (Optional)
414 Eon Guest Chair

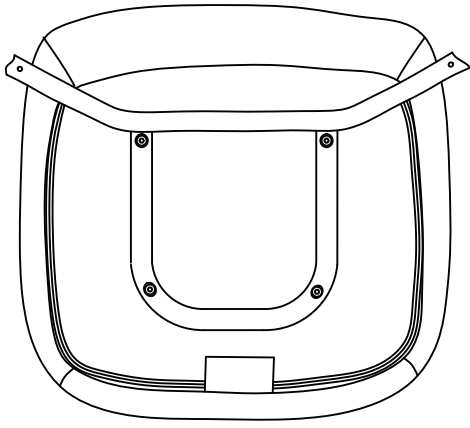

1) Remove seat from chair frame

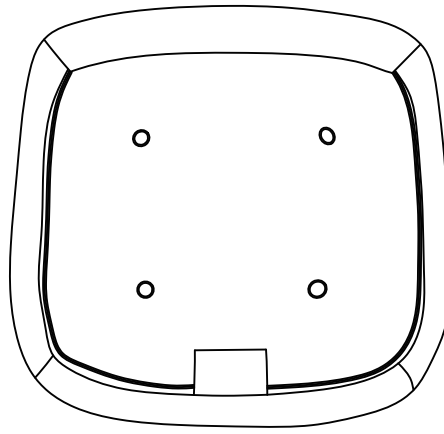

2) **Remove law label and weight capacity label and put to the side.**
Unzip and the old slip cover and remove

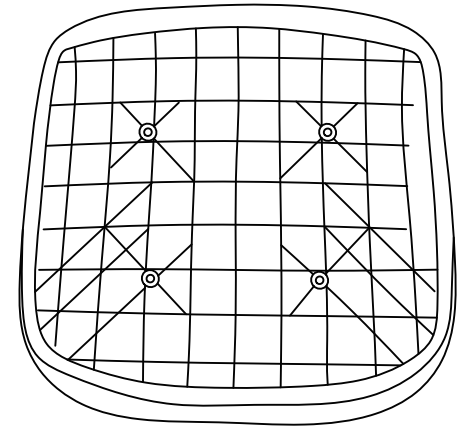

3) Install new slip cover. Make sure all 4 slip cover corners match the foam corners, top and bottom holes on bottom of slip cover match to holes on the seat pan

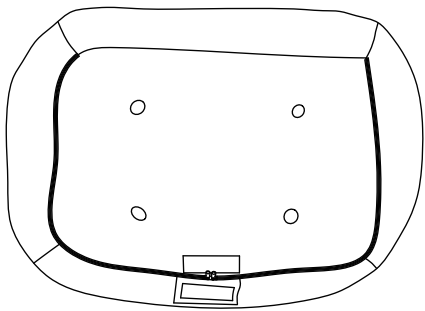

4) Re-attach the seat pan to the slip cover using the four screws from step 1. **Re-apply the law label and weight capacity label. Make sure labels are pressed down hard to ensure attachment**